

# Consumables



QUANTANALITICA



## DigFILTERs - FILTER PARTICULATES PRIOR TO SAMPLE ANALYSIS

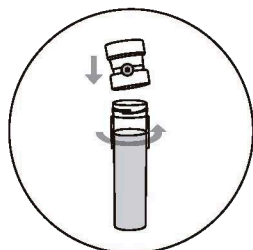

Screw the **DigFILTER** (using the end with the plug) onto a 50 ml **DigTUBE** containing a cooled sample.

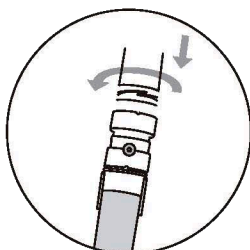

Screw a clean **DigTUBE** onto the opposite end of the **DigFILTER**.

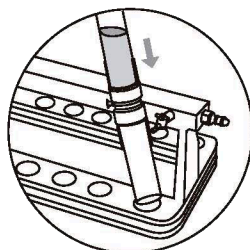

Flip the tube-filter assembly over so that the tube containing the sample is now on top. Attach the assembly to the manifold, inserting the valve into the filter port.

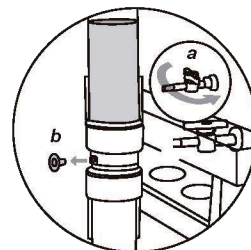

Open the valve and remove the plug from the opposite port.

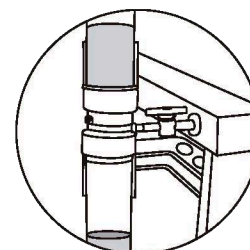

Turn on the vacuum pump and watch your sample filter.

DESCRIPTION	PACKAGING	QUANTITY	CATALOGUE NUMBER
<b>DigFILTER</b> - 0.45 micron, Teflon®	Bulk	100	010-500-070
<b>DigFILTER</b> 0.7 micron for TCLP	Bulk	100	010-500-082
<b>DigFILTER</b> - 1.0 micron, Teflon®	Bulk	100	010-500-080
<b>DigFILTER</b> Manifold -12 position	-	Each	010-500-230
<b>DigFILTER</b> Manifold - 4 position	-	Each	010-500-234

Visit us to view video online:

[www.scpsscience.com](http://www.scpsscience.com)



## DigTUBEs - THE CLEANEST DIGESTION TUBES ON THE MARKET

Single-use, all-in-one vessels eliminate the need for five separate vessels: Digestion beakers, volumetric flasks, graduated cylinders, autosampler tubes and storage containers. 15 ml, 50 ml and 100 ml **DigTUBEs** for sample digestion and standard auto samplers. **DigTUBEs** are ideal for sample evaporation.

### FEATURES:

- Transparent with easy-to-read graduations
- Accurate 50 or 100 ml graduation is calibrated to meet Class A specifications
- Leak-free screw cap
- RackLock design allows for easy one-handed closure of the screw cap
- Flat bottom for optimum heat transfer



## DigTUBEs AND WATCH GLASSES

DESCRIPTION	PACKAGING	QUANTITY	CATALOGUE NUMBER
15 ml <b>DigTUBEs</b> - w/ RackLock and blue caps	Bulk	1620	010-515-261
15 ml <b>DigTUBEs</b> - w/o RackLock and blue caps	Bulk	1620	010-515-263
50 ml <b>DigTUBEs</b> - w/ RackLock and blue caps*	Bulk	750	010-500-261
50 ml <b>DigTUBEs</b> - w/o RackLock and blue caps*	Bulk	750	010-500-263
Watch Glasses Polypropylene ribbed w/ "handle" for 50 ml tubes	Dispenser boxes	1000	010-500-081
100 ml <b>DigTUBEs</b> - w/ RackLock and blue caps	Bulk	300	010-501-261
100 ml <b>DigTUBEs</b> - w/o RackLock and blue caps	Bulk	300	010-501-263
Watch Glasses Polypropylene ribbed w/ "handle" for 100 ml tube	Dispenser boxes	500	010-501-081